

APPLICATION TO INSTALL PRIVATE LINE

DATE: 8-28-14

TO THE COMMISSIONERS COURT OF BROWN COUNTY,

Application is hereby made by Zephyr WSC, to install a buried or aerial

line within the right-of-way and/or across a county road in Brown County, Texas, as follows:

Precinct # 3 7375 CR 350

The location and description of the proposed line and associated appurtenances is more fully shown by the plat of such line attached to this application. The line will be constructed and maintained on the County right-of-way in accordance with governing laws. And installed at a depth of 24" to 30" below the lowest level of the bar ditch.

The applicant agrees to remove or relocate such fixtures at his own expense so as to permit the widening or changing of traffic lanes or reconstruction of the roadbed. Such removal or relocation shall be within 30 days of written notice specifying the fixtures to be moved and indicate the place on the roadway to which they shall be replaced.

Notwithstanding any other provision contained herein, it is expressly understood that tender of this notice by the undersigned does not constitute a waiver, surrender, abandonment or impairment of any property rights, franchise, easement, license, authority, permission, privilege or right now granted by law or may be granted in the future and any provision of provisions so construed shall be null and void.

The Commissioner of the above precinct will be notified of the time and date of installation at least 24 hours in advance.

I certify that the above-proposed installation will not impair or harm the ingress and egress of adjacent landowners.

Construction of this line will begin on or after the 01 day of Sept, 20 14

BY: Mike Beul

Address PO Box 722

Zephyr Tex 76890

642-9511

Approved "ditch work" 7/2/14

September 2, 2014
(Exhibit #9)

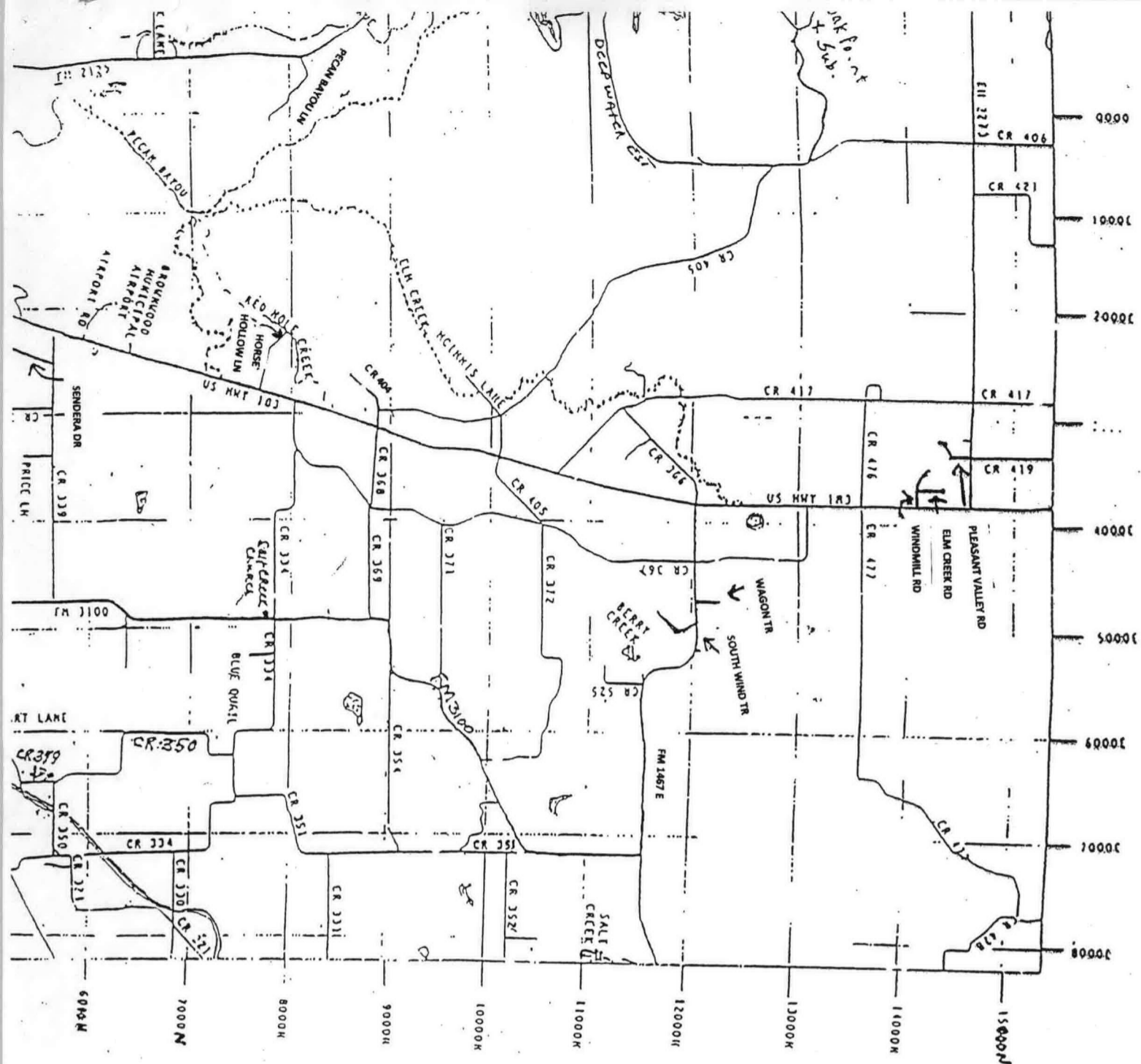

COUNTY ROADS

| NO. | GRID |
|-------|------|
| 320 | K-8 |
| 321 | J-10 |
| 330 | I-10 |
| 331 | G-10 |
| 332 | K-10 |
| 333 | K-10 |
| 334 | H-7 |
| 337 | K-5 |
| 338 | K-5 |
| 339 | J-6 |
| 340 | J-6 |
| 344 | K-6 |
| 345 | K-8 |
| 348 | K-9 |
| 349 | I-9 |
| 350 | J-9 |
| 351 | G-9 |
| 352 | E-10 |
| 354 | G-9 |
| 366 | D-6 |
| 367 | D-7 |
| 368 | G-6 |
| 369 | G-7 |
| 371 | F-7 |
| 372 | E-7 |
| 381 | K-4 |
| 382 | K-4 |
| 404 | G-5 |
| 405 | E-6 |
| 406 | A-3 |
| 417 | A-5 |
| 419 | A-6 |
| 421 | A-3 |
| 422 | A-1 |
| 423 W | A-1 |
| 465 | F-1 |
| 476 | B-6 |
| 477 | B-7 |
| 478 | A-10 |
| 525 | D-8 |
| 613 | K-8 |
| 617 | C-1 |

HIGHWAYS

| NO. | GRID |
|------------|------|
| PARK RD 15 | E-1 |
| 67-377 E | K-8 |
| 183 N | H-5 |

COMMUNITIES
SUBDIVISIONS
PRIVATE ROADS

| NAME | GRID |
|---------------------|------|
| 13 TH ST | F-2 |
| AIRPORT RD | I-5 |
| BLUEBONNET LN | G-1 |
| BLUE QUAIL | H-8 |
| BAPT. ENCAMPMENT RD | G-1 |
| C & E LN | G-2 |
| COUNTRY PLACE LN | H-1 |
| DEEPWATER RD | E-2 |
| ELM CREEK RD | A-6 |
| HARBOR POINT | A-1 |
| HORSE HOLLOW LN | H-5 |
| LK BWD DAM AREA | G-1 |
| LAKE HAVEN | F-2 |
| MATTIE B LN | F-1 |
| MCINNIS LN | F-6 |
| MORELOCK LN | I-2 |
| OAK POINT SUB. | C-2 |
| OAK ST | K-5 |
| OLD MAY RD | K-4 |
| PECAN BAYOU LN | G-2 |
| PLEASANT VALLEY RD | A-6 |
| PRICE LN | I-6 |
| ROCKY TRAILS | C-8 |
| SENDERA DR | J-5 |
| SHADY OAKS DR | H-1 |
| SOUTH WIND TRAILS | D-8 |
| STEWART LN | K-8 |
| TAMARACK MNT | A-1 |
| TRES COLINAS LN | H-1 |
| THUNDERBIRD BAY | A-1 |
| VALLEY VISTA DR | K-5 |
| WAGON TR | C-7 |

APPROVAL:

Zephyr Water
P.O. Box 722
Zephyr TX 76890

The Commissioner's Court of Brown County offers no objections to the location on the right-of-way and/or crossing of your proposed buried line as shown by accompanying drawings and notice dated August 28, 2014, except as noted below:

It is further intended that the Commissioner's Court may require the owner to relocate This line, subject to provisions of governing laws, by giving thirty (30) days written notice.

The installation shall not damage any part of the county road and adequate provisions must be made to cause a minimum inconvenience to traffic and adjacent property owners.

Please notify Wayne Shaw, Commissioner of Precinct # 3, Twenty-four (24) hours prior to starting construction of the line, in order that we may have a representative present.

BROWN COUNTY COMMISSIONERS COURT
OF BROWNWOOD, TEXAS

BY: E Ray West

Exceptions and/or special requirements: According to Brown County specifications